

## Rotule SI SIL6-T-K-DURBAL - SIL6-T-K-DURBAL

<https://www.123roulement.com/roulement-palier/rotule/si/sil6-t-k-durbal>

### SIL6-T-K



female thread:  
maintenance free,  
according to  
DIN ISO 12240-4,  
series K



**Description:** DIN ISO rod end K series. Made of spherical plain bearing DG...PW pressed into rod end body. Sliding combination steel / bronze-PTFE composite.

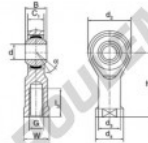

**Rod end body:**  
surface zinc plated

**Sliding combination:**  
steel / bronze-PTFE composite

**Inner ring:**  
bearing steel, hardened, ground and  
spherical surface chromium plated

**Outer ring:**  
brass body pressed around, outer race  
lined with bronze-PTFE composite

**Lubrication:**  
maintenance free

order number		measurement [mm]						
right hand thread	left hand thread	d	G	B	C <sub>1</sub>	d <sub>2</sub>	d <sub>3</sub>	d <sub>4</sub>
SIL 6 T/K		6	M 6	9	6,75	20	10,0	13

type	measurement [mm]			load rating C <sub>10</sub> [N]	weight [kg]
	l <sub>3</sub> min	W	h		
SI / SIL 6 T/K	12	11	30	7,7	0,022

## CARACTÉRISTIQUES PRODUIT

Marque	DURBAL
N° Ean13	3663952489117
Diam. intérieur	6 mm
Diam. extérieur	20 mm
Epaisseur	9 mm
Type	SI
Poids	22 g
Filetage	Filetage à gauche
Lubrification	sans
Conditionnement	1

[contact@123roulement.com](mailto:contact@123roulement.com)

03 59 36 04 90

CRT4 de Lesquin 60 Rue Du Haut De Sainghin 59273 Fretin FRANCE