

Rotule SI

SIL22-T-K-DURBAL - SIL22-T-K-DURBAL

<https://www.123roulement.com/roulement-palier/rotule/si/sil22-t-k-durbal>

SIL22-T-K



female thread:
maintenance free,
according to
DIN ISO 12240-4,
series K



Description: DIN ISO rod end K series. Made of spherical plain bearing DG...PW pressed into rod end body. Sliding combination steel / bronze-PTFE composite.

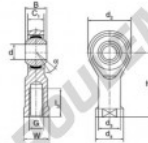

rod end body:
surface zinc plated

sliding combination:
steel / bronze-PTFE composite

inner ring:
bearing steel, hardened, ground and
spherical surface chromium plated

outer ring:
brass body pressed around, outer race
lined with bronze-PTFE composite

Lubrication:
maintenance free

| order number | | measurement (mm) | | | | | | |
|-------------------|------------------|------------------|------------|----|----------------|----------------|----------------|----------------|
| right hand thread | left hand thread | d | G | B | C ₁ | d ₂ | d ₃ | d ₄ |
| | SIL 22 T/K | 22 | M 22 x 1,5 | 28 | 20,00 | 54 | 30,0 | 38 |

| type | measurement (mm) | | | load rating C ₁₀ (N) | weight (kg) |
|-----------------|--------------------|----|----|---------------------------------------|----------------|
| | l ₁ min | W | h | | |
| SI / SIL 22 T/K | 37 | 32 | 84 | 15 | 68,0 |

CARACTÉRISTIQUES PRODUIT

| | |
|-----------------|-------------------|
| Marque | DURBAL |
| N° Ean13 | 3663952489575 |
| Diam. intérieur | 22 mm |
| Diam. extérieur | 54 mm |
| Epaisseur | 28 mm |
| Type | SI |
| Poids | 540 g |
| Filetage | Filetage à gauche |
| Lubrification | sans |
| Conditionnement | 1 |

contact@123roulement.com

03 59 36 04 90

CRT4 de Lesquin 60 Rue Du Haut De Sainghin 59273 Fretin FRANCE