

# Rotule SI

## SIL35-T-K-DURBAL - SIL35-T-K-DURBAL

<https://www.123roulement.com/roulement-palier/rotule/si/sil35-t-k-durbal>

### SIL35-T-K



female thread:  
maintenance free,  
according to  
DIN ISO 12240-4,  
series K



Description: DIN ISO rod end K series. Made of spherical plain bearing DG...PW pressed into rod end body. Sliding combination steel / bronze-PTFE composite.

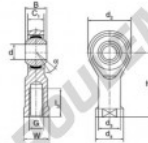

rod end body:  
surface zinc plated

Sliding combination:  
steel / bronze-PTFE composite

inner ring:  
bearing steel, hardened, ground and  
spherical surface chromium plated

Outer ring:  
brass body pressed around, outer race  
lined with bronze-PTFE composite

Lubrication:  
maintenance free

order number		measurement (mm)						
right hand thread	left hand thread	d	G	B	C <sub>1</sub>	d <sub>2</sub>	d <sub>3</sub>	d <sub>4</sub>
	<b>SIL 35 T/K</b>	35	M 36 x 2	43	28,00	81	46,0	58

type	measurement (mm)			h	d <sub>1</sub>	load rating C <sub>0</sub> (N)	weight (kg)
	l <sub>1</sub> min	W					
SI / SIL 35 T/K	56	50	125	16			1,600

## CARACTÉRISTIQUES PRODUIT

Marque	DURBAL
N° Ean13	3663952489803
Diam. intérieur	35 mm
Diam. extérieur	81 mm
Epaisseur	43 mm
Type	SI
Poids	1600 g
Filetage	Filetage à gauche
Lubrification	sans
Conditionnement	1

[contact@123roulement.com](mailto:contact@123roulement.com)

03 59 36 04 90

CRT4 de Lesquin 60 Rue Du Haut De Sainghin 59273 Fretin FRANCE