

Rotule SI SI40-T-K-DURBAL - SI40-T-K-DURBAL

<https://www.123roulement.com/roulement-palier/rotule/si/si40-t-k-durbal>

SI40-T-K



female thread:
maintenance free,
according to
DIN ISO 12240-4,
series K



Description: DIN ISO rod end K series. Made of spherical plain bearing DG...PW pressed into rod end body. Sliding combination steel / bronze-PTFE composite.

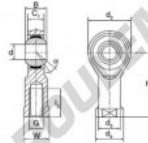

Rod end body:
surface zinc plated

Sliding combination:
steel / bronze-PTFE composite

Inner ring:
bearing steel, hardened, ground and
spherical surface chromium plated

Outer ring:
brass body pressed around, outer race
lined with bronze-PTFE composite

Lubrication:
maintenance free

order number		measurement [mm]						
right hand thread	left hand thread	d	G	B	C ₁	d ₂	d ₃	d ₄
SI 40 TIK		40	M 42 x 2	49	33,00	91	53,0	65

type	measurement [mm]			h	d ₁ PT	load rating C ₀ [kN]	weight [kg]
	l ₁ min	W					
SI / SIL 40 TIK	60	55	142	17			2,400

CARACTÉRISTIQUES PRODUIT

Marque	DURBAL
N° Ean13	3663952489841
Diam. intérieur	40 mm
Diam. extérieur	91 mm
Epaisseur	49 mm
Type	-
Poids	2400 g
Filetage	-
Lubrification	-
Conditionnement	-

contact@123roulement.com

03 59 36 04 90

CRT4 de Lesquin 60 Rue Du Haut De Sainghin 59273 Fretin FRANCE