

Rotule SA SA28-T-K-DURBAL - SA28-T-K-DURBAL

<https://www.123roulement.com/roulement-palier/rotule/sa/sa28-t-k-durbal>

SA28-T-K



male thread;
maintenance free,
according to
DIN ISO 12240-4,
series K



Description: DIN ISO rod end K series. Made of spherical plain bearing DG...PW pressed into rod end body. Sliding combination steel / bronze-PTFE composite.

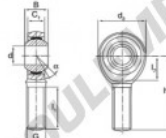

Rod end body:
surface zinc plated

Sliding combination:
steel / bronze-PTFE composite

Inner ring:
bearing steel, hardened, ground and
spherical surface chromium plated

Outer ring:
brass body pressed around, outer race
lined with bronze-PTFE composite

Lubrication:
maintenance free

order number	measurement [mm]		C ₁	d ₂
	d	G		
SA 28 T/K	28	M 27 x 2	35	24,00

type	measurement [mm]		h	α [°]	Tragzahlen C ₀ [kN]	weight [kg]
	l ₁ min	l ₂				
SA / SAL 28 T/K	62	33	103	15	107,0	0,800

CARACTÉRISTIQUES PRODUIT

Marque	DURBAL
N° Ean13	3663952490366
Diam. intérieur	28 mm
Diam. intérieur	1.102" inch
Diam. extérieur	66 mm
Diam. extérieur	2.598" inch
Epaisseur	35 mm
Epaisseur	1.378" inch
Type	SA
Poids	800 g
Filetage	Filetage à droite
Lubrification	sans
Conditionnement	1

contact@123roulement.com

03 59 36 04 90

CRT4 de Lesquin 60 Rue Du Haut De Sainghin 59273 Fretin FRANCE