

## Rotule SA SAL30-T-K-DURBAL - SAL30-T-K-DURBAL

https://www.123roulement.com/roulement-palier/rotule/sa/sal30-t-k-durbal

### SAL30-T-K



male thread;  
maintenance free,  
according to  
DIN ISO 12240-4,  
series K



Description: DIN ISO rod end K series. Made of spherical plain bearing DG...PW pressed into rod end body. Sliding combination steel / bronze-PTFE composite.

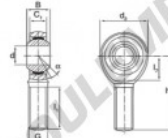

Rod end body:  
surface zinc plated

Sliding combination:  
steel / bronze-PTFE composite

Inner ring:  
bearing steel, hardened, ground and  
spherical surface chromium plated

Outer ring:  
brass body pressed around, outer race  
lined with bronze-PTFE composite

Lubrication:  
maintenance free

order number		measurement [mm]				
right hand thread	left hand thread	d	G	B	C <sub>1</sub>	d <sub>2</sub>
SAL 30 T/K		30	M 30 x 2	37	25,00	70

type	measurement [mm]				Tragzahlen C <sub>10</sub> [kN]	weight [kg]
	l <sub>1</sub> min	l <sub>2</sub>	h	α [°]		
SA / SAL 30 T/K	66	35	110	17	114,0	1,100

## CARACTÉRISTIQUES PRODUIT

Marque	DURBAL
N° Ean13	3663952490403
Diam. intérieur	30 mm
Diam. extérieur	70 mm
Epaisseur	37 mm
Type	SA
Poids	1100 g
Filetage	Filetage à gauche
Lubrification	sans
Conditionnement	1

[contact@123roulement.com](mailto:contact@123roulement.com)

03 59 36 04 90

CRT4 de Lesquin 60 Rue Du Haut De Sainghin 59273 Fretin FRANCE