

Rotule SA SAL6-E-DURBAL - SAL6-E-DURBAL

<https://www.123roulement.com/roulement-palier/rotule/sa/sal6-e-durbal>

SAL6-E



male thread:
lubrication
is necessary,
according to
DIN ISO 12240-4,
series E

Description: DIN ISO rod end E series. Made of spherical plain bearing DGE...E (ES) pressed into rod end body. Sliding combination steel / steel. Maintenance necessary. Bore diameter $d \geq 15$ with grease nipple in rod end body and lubrication groove and hole in inner and outer ring. Bore diameter $d \geq 15$ type DSA...ES-2RS with additional seals also available.

rod end body:
surface zinc plated

Sliding combination:
steel / steel

Inner ring:
bearing steel, hardened, ground and phosphated

Outer ring:
bearing steel, hardened, ground and phosphated

Lubrication:
lubrication is necessary

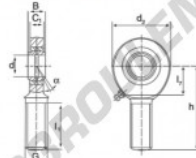

order number		measurement [mm]					
right hand thread	left hand thread	d	G	B	C ₁	d ₂	
	SAL 6 E	6	M 6	6	4,4	21	
type	l ₁ min	l ₂	h	n [°]	load rating C ₀ [kN]	weight [kg]	
SA / SAL 6 E	18	11	36	13	8,2	0,017	

CARACTÉRISTIQUES PRODUIT

Marque	DURBAL
N° Ean13	3663952497877
Diam. intérieur	6 mm
Diam. extérieur	21 mm
Epaisseur	6 mm
Type	SA
Poids	17 g
Filetage	Filetage à gauche
Lubrification	avec
Conditionnement	1

contact@123roulement.com

03 59 36 04 90

CRT4 de Lesquin 60 Rue Du Haut De Sainghin 59273 Fretin FRANCE