

Rotule SA SAL15-ES-DURBAL - SAL15-ES-DURBAL

<https://www.123roulement.com/roulement-palier/rotule/sa/sal15-es-durbal>

SAL15-ES



male thread:
lubrication
is necessary,
according to
DIN ISO 12240-4,
series E

Description: DIN ISO rod end E series. Made of spherical plain bearing DGE...E (ES) pressed into rod end body. Sliding combination steel / steel. Maintenance necessary. Bore diameter $d \geq 15$ with grease nipple in rod end body and lubrication groove and hole in inner and outer ring. Bore diameter $d \geq 15$ type DSA...ES-2RS with additional seals also available.

rod end body:
surface zinc plated

Sliding combination:
steel / steel

Inner ring:
bearing steel, hardened, ground and phosphated

Outer ring:
bearing steel, hardened, ground and phosphated

Lubrication:
lubrication is necessary

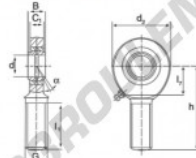

order number		measurement [mm]				
right hand thread	left hand thread	d	G	B	C ₁	d ₂
	SAL 15 ES	15	M 14	12	10,0	40

type	measurement [mm]				n [°]	load rating C ₀ [kN]	weight [kg]
	l ₁ min	l ₂	h				
SA / SAL 15 ES	34	20	63	8	36,0	0,140	

CARACTÉRISTIQUES PRODUIT

Marque	DURBAL
N° Ean13	3663952498072
Diam. intérieur	15 mm
Diam. intérieur	0.591" inch
Diam. extérieur	40 mm
Diam. extérieur	1.575" inch
Epaisseur	12 mm
Epaisseur	0.472" inch
Type	SA
Poids	140 g
Filetage	Filetage à gauche
Lubrification	avec
Conditionnement	-
Norme	Sans norme

contact@123roulement.com

03 59 36 04 90

CRT4 de Lesquin 60 Rue Du Haut De Sainghin 59273 Fretin FRANCE