

Rotule SA SA50-ES-DURBAL - SA50-ES-DURBAL

<https://www.123roulement.com/roulement-palier/rotule/sa/sa50-es-durbal>

SA50-ES



male thread:
lubrication
is necessary,
according to
DIN ISO 12240-4,
series E

Description: DIN ISO rod end E series. Made of spherical plain bearing DGE...E (ES) pressed into rod end body. Sliding combination steel / steel. Maintenance necessary. Bore diameter $d \geq 15$ with grease nipple in rod end body and lubrication groove and hole in inner and outer ring. Bore diameter $d \geq 15$ type DSA...ES-2RS with additional seals also available.

rod end body:
surface zinc plated

Sliding combination:
steel / steel

Inner ring:
bearing steel, hardened, ground and phosphated

Outer ring:
bearing steel, hardened, ground and phosphated

Lubrication:
lubrication is necessary

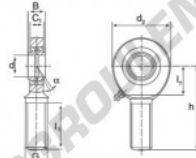

order number		measurement [mm]				
right hand thread	left hand thread	d	G	B	C ₁	d ₂
SA 50 ES		50	M 45 x 3	35	30,0	112

type	measurement [mm]				n [°]	load rating C ₀ [kN]	weight [kg]
	l ₁ min	l ₂	h				
SA / SAL 50 ES	107	56	185		6	290,0	3,400

CARACTÉRISTIQUES PRODUIT

Marque	DURBAL
N° Ean13	3663952498676
Diam. intérieur	50 mm
Diam. extérieur	112 mm
Epaisseur	35 mm
Type	SA
Poids	3400 g
Filetage	Filetage à droite
Lubrification	avec
Conditionnement	1

contact@123roulement.com

03 59 36 04 90

CRT4 de Lesquin 60 Rue Du Haut De Sainghin 59273 Fretin FRANCE