

Rotule SA SAL60-ES-DURBAL - DSAL60-ES-DURBAL

<https://www.123roulement.com/roulement-palier/rotule/sa/dsal60-es-durbal>

SAL60-ES



male thread:
lubrication
is necessary,
according to
DIN ISO 12240-4,
series E

Description: DIN ISO rod end E series. Made of spherical plain bearing DGE...E (ES) pressed into rod end body. Sliding combination steel / steel. Maintenance necessary. Bore diameter $d \geq 15$ with grease nipple in rod end body and lubrication groove and hole in inner and outer ring. Bore diameter $d \geq 15$ type DSA...ES-2RS with additional seals also available.

rod end body:
surface zinc plated

Sliding combination:
steel / steel

Inner ring:
bearing steel, hardened, ground and phosphated

Outer ring:
bearing steel, hardened, ground and phosphated

Lubrication:
lubrication is necessary

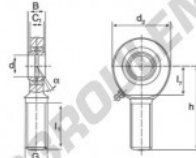

| order number | | measurement [mm] | | | | | |
|-------------------|------------------|------------------|----------|----|----------------|----------------|--|
| right hand thread | left hand thread | d | G | B | C ₁ | d ₂ | |
| | SAL 60 ES | 60 | M 52 x 3 | 44 | 38,0 | 135 | |

| type | l ₁ min | l ₂ | h | n [°] | load rating C ₀ [kN] | weight [kg] |
|----------------|--------------------|----------------|-----|----------|---------------------------------------|----------------|
| SA / SAL 60 ES | 115 | 60 | 210 | 6 | 450,0 | 5,900 |

CARACTÉRISTIQUES PRODUIT

| | |
|-----------------|-------------------|
| Marque | DURBAL |
| N° Ean13 | 3663952498751 |
| Diam. intérieur | 60 mm |
| Diam. extérieur | 135 mm |
| Epaisseur | 44 mm |
| Type | SA |
| Poids | 5900 g |
| Filetage | Filetage à gauche |
| Lubrification | avec |
| Conditionnement | 1 |

contact@123roulement.com

03 59 36 04 90

CRT4 de Lesquin 60 Rue Du Haut De Sainghin 59273 Fretin FRANCE