

Rotule TAPR GIHR35-DO-DURBAL - GIHR35-DO-DURBAL

<https://www.123roulement.com/roulement-palier/rotule/tapr/gihr35-do-durbal>

GIHR35-DO



Description: Hydraulic rod end. Made of spherical plain bearing DGE...ES pressed into rod end housing. Sliding combination steel / steel, with grease nipple.

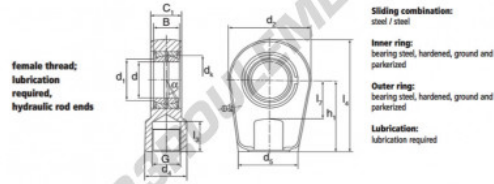

female thread:
lubrication
required,
hydraulic rod ends

Sliding combination:
steel / steel

inner ring:
bearing steel, hardened, ground and
polished

Outer ring:
bearing steel, hardened, ground and
polished

Lubrication:
lubrication required

order number	d	d ₁	G	d ₂	B	C ₁	d ₂
GIHR 35 DO	35	39,7	M 28 x 1,5	40	66	25	30 78

type	l ₁ min	l ₂ min	h ₁	l ₂	d ₁	α [°]	load rating C ₀ [kN]	weight [kg]
GIHR / GIHL 35 DO	29	38	70	112,0	47,0	6	153	1,20

CARACTÉRISTIQUES PRODUIT

Marque	DURBAL
N° Ean13	3663952499635
Diam. intérieur	35 mm
Diam. extérieur	78 mm
Epaisseur	30 mm
Type	TAPR
Poids	1200 g
Filetage	Filetage à droite
Lubrification	avec
Conditionnement	1

contact@123roulement.com

03 59 36 04 90

CRT4 de Lesquin 60 Rue Du Haut De Sainghin 59273 Fretin FRANCE