

Rotule SA BEM20-20-501-DURBAL - BEM20-20-501-DURBAL

<https://www.123roulement.com/roulement-palier/rotule/sa/bem20-20-501-durbal>

BEM20-20-501



male thread:
maintenance free,
adapter sizes
according to
DIN ISO 12240-4,
series K



**DURBAL® heavy-duty rod ends
with integral spherical
plain bearing**

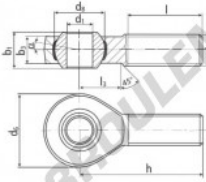

rod end housing:
forged steel, tempered, rolled thread,
surface galvanized, free of Cr-VI

joint ball:
ball bearing steel, hardened and ground,
surface superfinished and chromium
plated

race:
nylon / teflon / glass fibre compound

tolerances:
see page 10

order number		measurements [mm]			weight		basic load rating	
type	type	d ₁	d ₂	d ₃	d ₄	l ₁	l ₂	d ₅
BEM 20 -20 -501		20	M 20 x 1,5	50	34,87	25	18,0	
measurements [mm]		weight		basic load rating				
type	h	l	l ₃	α ₁ [°]	α ₂ [°]	C	C ₁₀	C ₁₀
BEM 20	78	47	28	14,5	9,0	0,327	30805	82200

CARACTÉRISTIQUES PRODUIT

Marque	DURBAL
N° Ean13	3663952507903
Diam. intérieur	20 mm
Diam. intérieur	0.787" inch
Diam. extérieur	50 mm
Diam. extérieur	1.969" inch
Epaisseur	25 mm
Epaisseur	0.984" inch
Type	SA
Poids	327 g
Filetage	Filetage à droite
Lubrification	sans
Conditionnement	1
Norme	Sans norme

contact@123roulement.com

03 59 36 04 90

CRT4 de Lesquin 60 Rue Du Haut De Sainghin 59273 Fretin FRANCE