

# Rotule SA BEM22-20-501-DURBAL - BEM22-20-501-DURBAL

<https://www.123roulement.com/roulement-palier/rotule/sa/bem22-20-501-durbal>

## BEM22-20-501



male thread:  
maintenance free,  
adapter sizes  
according to  
DIN ISO 12240-4,  
series K



**DURBAL® heavy-duty rod ends  
with integral spherical  
plain bearing**

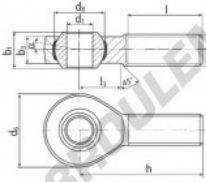

rod end housing:  
forged steel, tempered, rolled thread,  
surface galvanized, free of Cr-VI

joint ball:  
ball bearing steel, hardened and ground,  
surface superfinished and chromium  
plated

race:  
nylon / teflon / glass fibre compound

tolerances:  
see page 10

order number		measurements [mm]			weight		basic load rating	
type	type	d <sub>1</sub>	d <sub>2</sub>	d <sub>3</sub>	d <sub>4</sub>	l <sub>1</sub>	l <sub>2</sub>	l <sub>3</sub>
BEM 22 -20 -501		22	M 22 x 1,5	54	38,05	28	20,0	
measurements [mm]		weight		basic load rating				
type	h	l	l <sub>3</sub>	α <sub>1</sub> °	α <sub>2</sub> °	dyn. C	stat. C <sub>0</sub>	
BEM 22	84	51	26	15,5	10,0	0,440	38230 95600	

## CARACTÉRISTIQUES PRODUIT

Marque	DURBAL
N° Ean13	3663952507934
Diam. intérieur	22 mm
Diam. extérieur	54 mm
Epaisseur	28 mm
Type	SA
Poids	440 g
Filetage	Filetage à droite
Lubrification	sans
Conditionnement	1

[contact@123roulement.com](mailto:contact@123roulement.com)

03 59 36 04 90

CRT4 de Lesquin 60 Rue Du Haut De Sainghin 59273 Fretin FRANCE