

Rotule SA BEM30-20-501-DURBAL - BEM30-20-501-DURBAL

<https://www.123roulement.com/roulement-palier/rotule/sa/bem30-20-501-durbal>

BEM30-20-501



male thread:
maintenance free,
adapter sizes
according to
DIN ISO 12240-4,
series K



**DURBAL® heavy-duty rod ends
with integral spherical
plain bearing**

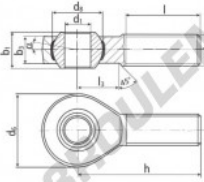

rod end housing:
forged steel, tempered, rolled thread,
surface galvanized, free of Cr-VI

joint ball:
ball bearing steel, hardened and ground,
surface superfinished and chromium
plated

race:
nylon / teflon / glass fibre compound

tolerances:
see page 10

order number		measurements [mm]		weight		basic load rating	
type	type	d ₁	d ₂	d ₄	d ₅	b ₁	b ₂
BEM 30 -20 -501		30	M 30 x 2	70	50,75	37	25,0
measurements [mm]		weight		basic load rating			
type	h	l	l ₃	α ₁ °	α ₂ °	d _{ym}	stat.
BEM 30	110	66	35	17,0	10,5	[kg]	[N] [N]

CARACTÉRISTIQUES PRODUIT

Marque	DURBAL
N° Ean13	3663952507972
Diam. intérieur	30 mm
Diam. extérieur	70 mm
Épaisseur	37 mm
Type	-
Poids	1015 g
Filetage	-
Lubrification	-
Conditionnement	-

contact@123roulement.com

03 59 36 04 90

CRT4 de Lesquin 60 Rue Du Haut De Sainghin 59273 Fretin FRANCE