

Rotule SI

EF45-20-501-DURBAL - EF45-20-501-DURBAL

<https://www.123roulement.com/roulement-palier/rotule/si/ef45-20-501-durbal>

EF45-20-501



rod end housing:
forged steel, tempered, surface galvanized, free of Cr VI

joint ball:
ball bearing steel, hardened and ground, surface superfinished and chromium plated

race:
nylon / teflon / glass fibre compound

tolerances:
see page 10

DURBAL® heavy-duty rod ends with integral spherical plain bearing

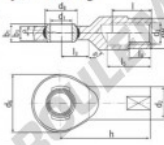

female thread:
maintenance free, adapter sizes according to DIN ISO 12240-4, series E / EH



order number			measurements [mm]							weight	basic load rating		
type	right-hand thread	left-hand thread	d ₁	d ₂	d ₃	d ₄	d ₅	b ₁	b ₂		b ₃	b ₄	C
EF 45	-20	-501	45	67	M 45 x 3	102	60,0	32	25	165			
measurements [mm]			weight				basic load rating						
type	l	l ₃	l ₄	l ₅	SW	α ₁ ¹	α ₂ ¹	[kg]	C	[N]	C ₀	[N]	
EF 45	50	45	76	55		7,5	4,0	3,085	107000		276200		

CARACTÉRISTIQUES PRODUIT

Marque	DURBAL
N° Ean13	3663952508610
Diam. intérieur	45 mm
Diam. extérieur	102 mm
Epaisseur	32 mm
Type	SI
Poids	3085 g
Filetage	Filetage à droite
Lubrification	sans
Conditionnement	1

contact@123roulement.com

03 59 36 04 90

CRT4 de Lesquin 60 Rue Du Haut De Sainghin 59273 Fretin FRANCE