

Rotule SI BEF16-60-502-DURBAL - BEF16-60-502-DURBAL

<https://www.123roulement.com/roulement-palier/rotule/si/bef16-60-502-durbal>

BEF16-60-502



rod end heading:
stainless steel 1.4301, rolled thread,
surface with pickling treatment

joint ball:
stainless steel, hardened and ground,
surface superfinished

race:
nylon / teflon / glass fibre compound

tolerances:
see page 10

**DURBAL® heavy-duty rod ends
with integral spherical
plain bearing in stainless steel**

female thread:
maintenance free,
adapter sizes
according to
DIN ISO 12240-4,
series K,
thread according to
ISO 8139

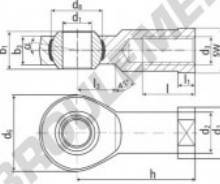

order number		measurements [mm]									
type	right hand thread / left hand thread	d ₁	d ₂	d ₃	d ₄	d ₅	d ₆	d ₇	d ₈	b ₁	b ₃
BEF 16	-60	-502	16	22,0	M 16	42	27	28,52	21	15,0	
measurements [mm]		weight							basic load rating		
type	h	l	l ₁	l ₂	l ₃	SW	α ₁ [°]	α ₂ [°]	β [°]	C [N]	C ₀ [N]
BEF 16	64	28	8,0	22	22	15,5	8,5	0,233		13760	39700

CARACTÉRISTIQUES PRODUIT

Marque	DURBAL
N° Ean13	3663952509501
Diam. intérieur	16 mm
Diam. intérieur	0.63" inch
Diam. extérieur	42 mm
Diam. extérieur	1.654" inch
Epaisseur	21 mm
Epaisseur	0.827" inch
Type	SI
Poids	233 g
Filetage	Filetage à gauche
Lubrification	sans
Conditionnement	1

contact@123roulement.com

03 59 36 04 90

CRT4 de Lesquin 60 Rue Du Haut De Sainghin 59273 Fretin FRANCE