

Rotule SA

BEM05-60-502-DURBAL - BEM05-60-502-DURBAL

<https://www.123roulement.com/roulement-palier/rotule/sa/bem05-60-502-durbal>

BEM05-60-502



male thread;
maintenance free,
adapter sizes
according to
DIN ISO 12240-4,
series K



**DURBAL® heavy-duty rod ends
with integral spherical
plain bearing in stainless steel**

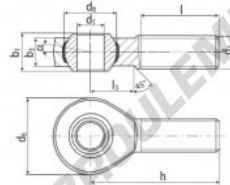

rod end housing:
stainless steel 1.4301, rolled thread,
surface with pickling treatment

joint ball:
stainless steel, hardened and ground,
surface superfinished

race:
nylon / teflon / glass fibre compound

tolerances:
see page 10

order number		right-hand thread		left-hand thread		measurements [mm]					
type		d ₁	d ₂	d ₃	d ₄	l ₁	l ₂	l ₃	h	b ₁	b ₂
BEM 05 -60	-502	5	M 5	18	11,06	8	6,0				
type		measurements [mm]			weight	basic load rating					
type		h	l	l ₃	α ₁ ¹ [°]	α ₂ ² [°]	[kg]	C	C ₀	C ₁₀	C ₂₀
BEM 05		33	20	9	13,0	7,5	0,014	2400			3500

CARACTÉRISTIQUES PRODUIT

Marque	DURBAL
N° Ean13	3663952509679
Diam. intérieur	5 mm
Diam. extérieur	18 mm
Epaisseur	8 mm
Type	SA
Poids	14 g
Filetage	Filetage à gauche
Lubrification	sans
Conditionnement	1

contact@123roulement.com

03 59 36 04 90

CRT4 de Lesquin 60 Rue Du Haut De Sainghin 59273 Fretin FRANCE