

Rotule SA BEM06-60-501-DURBAL - BEM06-60-501-DURBAL

<https://www.123roulement.com/roulement-palier/rotule/sa/bem06-60-501-durbal>

BEM06-60-501



male thread;
maintenance free,
adapter sizes
according to
DIN ISO 12240-4,
series K

**DURBAL® heavy-duty rod ends
with integral spherical
plain bearing in stainless steel**

rod end housing:
stainless steel 1.4301, rolled thread,
surface with pickling treatment

joint ball:
stainless steel, hardened and ground,
surface superfinished

race:
nylon / teflon / glass fibre compound

tolerances:
see page 10

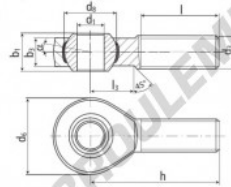

| order number | | measurements [mm] | | weight | | basic load rating | |
|-------------------|-------------------------------------|-------------------|----------------|--------------------|--------------------|-------------------|----------------|
| type | right-hand thread, left-hand thread | d ₁ | d ₂ | d ₃ | d ₄ | b ₁ | b ₂ |
| BEM 06 -60 | -501 | 6 | M 6 | 20 | 12,65 | 9 | 6,75 |
| measurements [mm] | | weight | | basic load rating | | dyn. stat. | |
| type | h | l | l ₃ | α ₁ [°] | α ₂ [°] | C | C ₀ |
| BEM 06 | 36 | 22 | 12 | 13,0 | 6,5 | 0,020 | 2820 4900 |

CARACTÉRISTIQUES PRODUIT

| | |
|-----------------|-------------------|
| Marque | DURBAL |
| N° Ean13 | 3663952509693 |
| Diam. intérieur | 6 mm |
| Diam. extérieur | 20 mm |
| Epaisseur | 9 mm |
| Type | SA |
| Poids | 20 g |
| Filetage | Filetage à droite |
| Lubrification | sans |
| Conditionnement | 1 |

contact@123roulement.com

03 59 36 04 90

CRT4 de Lesquin 60 Rue Du Haut De Sainghin 59273 Fretin FRANCE