

Rotule SA

BEM22-60-501-DURBAL - BEM22-60-501-DURBAL

<https://www.123roulement.com/roulement-palier/rotule/sa/bem22-60-501-durbal>

BEM22-60-501



male thread;
maintenance free,
adapter sizes
according to
DIN ISO 12240-4,
series K



**DURBAL® heavy-duty rod ends
with integral spherical
plain bearing in stainless steel**

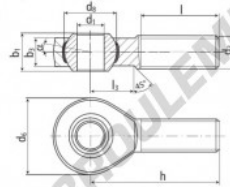

rod end housing:
stainless steel 1.4301, rolled thread,
surface with pickling treatment

joint ball:
stainless steel, hardened and ground,
surface superfinished

race:
nylon / teflon / glass fibre compound

tolerances:
see page 10

order number		measurements [mm]		measurements [mm]		weight		basic load rating	
type	right-hand thread, left-hand thread	d ₁	d ₂	d ₃	d ₄	b ₁	b ₂	dyn	stat.
BEM 22 -60	-501	22	M 22 x 1,5	54	38,05	28	20,0		
measurements [mm]		weight		basic load rating					
type	h	l	l ₃	α ₁ ¹ [°]	α ₂ ² [°]	[kg]	C	C ₀	C ₁₀
BEM 22	84	51	26	15,5	10,0	0,440	23480		63600

CARACTÉRISTIQUES PRODUIT

Marque	DURBAL
N° Ean13	3663952509860
Diam. intérieur	22 mm
Diam. extérieur	54 mm
Épaisseur	28 mm
Type	-
Poids	440 g
Filetage	-
Lubrification	-
Conditionnement	-

contact@123roulement.com

03 59 36 04 90

CRT4 de Lesquin 60 Rue Du Haut De Sainghin 59273 Fretin FRANCE