

Rotule SA

BEM1-2-20-501-DURBAL - BEM1-2-20-501-DURBAL

<https://www.123roulement.com/roulement-palier/rotule/sa/bem1-2-20-501-durbal>

BEM1/2-20-501



male thread; maintenance free, dimensions in inches

DURBAL® heavy-duty rod ends with integral spherical plain bearing

rod end housing: forged steel, tempered, rolled thread, surface galvanized, free of Cr VI

joint ball: ball bearing steel, hardened and ground, surface superfinished and chromium plated

race: nylon / tetlon / glass fibre compound

tolerances: see page 10

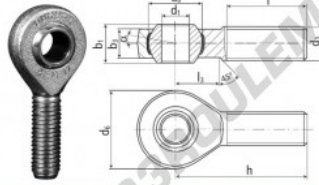

| order number | | measurements [inches] | | | | | weight | basic load rating dyn. C [N] | rolling stat. C ₀ [N] |
|--------------|------------------------------------|-----------------------|---------------------------|------------------------------------|------------------------------------|----------------|--------|---------------------------------------|---|
| type | right hand thread left hand thread | d ₁ | d ₂ class 2 | d ₃ | d ₄ | h ₁ | | | |
| BEM 1/2 -20 | -501 | 500 | 5000-20 UNF | 1.311 | .876 | .624 | .472 | | |
| | | measurements [inches] | | | | | weight | basic load rating dyn. C [N] | rolling stat. C ₀ [N] |
| type | h | l | l ₃ | α ₁ [°] [°] | α ₂ [°] [°] | [kg] | | | |
| BEM 1/2 | 2.460 | 1.500 | .846 | 13,0 | 9,5 | 0,109 | 14649 | 36624 | |

CARACTÉRISTIQUES PRODUIT

| | |
|-----------------|-------------------|
| Marque | DURBAL |
| N° Ean13 | 3663952510422 |
| Diam. intérieur | 12.7 mm |
| Diam. extérieur | 33.3 mm |
| Epaisseur | 15.85 mm |
| Type | SA |
| Poids | 109 g |
| Filetage | Filetage à droite |
| Lubrification | sans |
| Conditionnement | 1 |

contact@123roulement.com

03 59 36 04 90

CRT4 de Lesquin 60 Rue Du Haut De Sainghin 59273 Fretin FRANCE